

Solar Landscape: Application Supplements

Solar Landscape will include the following items during permit submission for each project:

- 777 W Wise Rd
 - 1200 W Irving Park Rd
 - 2400 Palmer Dr
 - 130 Hillcrest Blvd
- 1) An updated Landscape Plan which shows:
 - a. An aerial view of the plan
 - b. An elevation view of the plan
 - c. A plant list with the names and heights of plants to be installed
 - 2) A 3D Fence and Equipment view for permit prints
 - 3) Fence specs:
 - a. Chain Link
 - b. 16 Gauge
 - c. 3" posts
 - d. 7' height
 - e. Lockable man-gate or double swing gate (depending on equipment)

Attached please find examples of:

- 1) The Landscape Plan: 1200 W Irving Rd provided as an example
- 2) The 3D Fence and Equipment view: 1200 W Irving Rd and 2400 Palmer provided as an example

*Please note that the 3D Fence and Equipment views show example vegetation, the vegetation which will be installed will be the vegetation shown on the Landscape Plans.



LANDSCAPE NOTES

- ALL PLANT MATERIAL SHALL BE HARDY TO THE ZONE IT IS BEING PLANTED IN. ALL TREES AND SHRUBS ARE TO BE BALLED AND BURLAPED UNLESS OTHERWISE NOTED AND SHALL BE GROWN IN ACCORDANCE WITH THE STANDARDS SET FORTH BY THE LATEST EDITION OF AMERICAN STANDARD FOR NURSERY STOCK PUBLISHED BY AMERICANHORT.
- PLANT SIZES CALLED OUT ON THIS PLAN ARE THE MINIMUM SIZE REQUIRED. PLANTS WHICH FAIL TO MEET THE SIZES LISTED, SHALL BE REJECTED AT THE EXPENSE OF THE CONTRACTOR.
- CONTRACTOR MUST VERIFY ALL MATERIAL QUANTITIES AS DEPICTED ON THE DRAWING. THE PLANT LIST PROVIDED ON THIS PLAN IS FOR CONVENIENCE ONLY.
- SUBSTITUTIONS MAY NOT BE MADE WITHOUT THE APPROVAL OF THE LANDSCAPE ARCHITECT/DESIGNER.
- THE CONTRACTOR SHALL NOTIFY ALL APPROPRIATE AGENCIES AND UTILITY LOCATORS PRIOR TO CONSTRUCTION. CONTRACTOR SHALL NOT BEGIN ANY WORK ON-SITE UNTIL ALL UTILITIES HAVE BEEN LOCATED. CONTRACTOR SHALL OBTAIN "AS-BUILT" PLANS FOR ALL IRRIGATION AND LIGHTING PRIOR TO CONSTRUCTION.
- CONTRACTOR IS RESPONSIBLE FOR PROTECTING ALL UTILITIES INCLUDING IRRIGATION AND LIGHTING. ALL DAMAGE SHALL BE REPAIRED TO A NEW CONDITION IN ACCORDANCE WITH ALL CODES AT NO COST TO THE OWNER - SEE NOTE 5.
- ALL UNSUITABLE MATERIAL (CONCRETE, AGGREGATE, STONE, CRUSHED ASPHALT, BRICK ETC.) SHALL BE REMOVED, INCLUDING HAUL OFF, PRIOR TO PLANTING AND SHALL BE THE RESPONSIBILITY OF THE LANDSCAPE CONTRACTOR.
- SOIL MIX PM35 BY MIDWEST TRADING COMPANY OR EQUAL SHALL BE ROTOTILLED INTO ALL PERENNIAL AND ANNUAL PLANTING BEDS PRIOR TO THE INSTALLATION OF THE PLANT MATERIAL. A SLOW RELEASE, GRANULAR FERTILIZER SHALL BE APPLIED TO ALL ANNUAL AND PERENNIAL PLANTING BEDS AT THE RECOMMENDED RATE, AND SHALL BE ROTOTILLED IN WITH THE ABOVE SOIL MIXTURE BEFORE THE PLANT MATERIAL IS INSTALLED.
- CONTRACTOR TO PROVIDE THOROUGH INITIAL WATERING OF ALL PLANTINGS WITHIN 12 HOURS OF INSTALLATION TO ENSURE ALL AIR POCKETS HAVE BEEN REMOVED AROUND ROOT BALL.
- ALL PLANT BED AREAS ARE TO BE MULCHED WITH 3" OF DOUBLE SHREDDED HARDWOOD MULCH AND SHALL BE SEPARATED WITH A SPADE EDGE ALONG PERIMETERS ADJACENT TO TURF AREAS. FINAL GRADE (AFTER SETTLING) SHALL BE 1" BELOW ADJACENT CURBS.
- ALL TURF AREAS ARE TO BE A MINIMUM OF A FIVE WAY BLUEGRASS BLEND, UNLESS OTHERWISE NOTED. CONTRACTOR IS RESPONSIBLE FOR WATERING ALL INSTALLED TURF AREAS UNTIL TIME OF KNITTING. IF TURF SEED AND SOD OCCUR ON THE SAME PROJECT, CONTRACTOR SHALL VERIFY AND USE SEED MIXTURES TO MATCH SOD.
- AREAS TO BE SODDED SHALL BE WITH AN "APPROVED TURFGRASS SOD" OF PREMIUM GRADE. SOD SHALL BE A 5 WAY BLEND OF IMPROVED KENTUCKY BLUEGRASS VARIETIES THAT HAS BEEN GROWN LOCALLY TO THE PROJECT SITE. SOD MUST BE MATURED FOR 2 FULL GROWING SEASONS PRIOR TO HARVEST CUTTING AND BE HEALTHY WITH WELL ESTABLISHED ROOTS. SOD SHALL BE FREE OF DISEASE, INSECTS AND DEBRIS. SOD SHALL BE UNIFORM IN LEAF COLOR, TEXTURE, AND DENSITY. SOD SHALL BE DELIVERED, INSTALLED, AND WATERED WITHIN 24 HOURS OF HARVEST IN WHICH TEMPERATURES DO NOT EXCEED 90 DEGREES (F) NOR LESS THAN 55 DEGREES (F). SOD SHALL BE MACHINE-CUT AT A MINIMUM UNIFORM SOIL THICKNESS (1.5" OF SOD IS DESIRED) BUT SOD THICKNESS SHALL BE A THICKNESS NECESSARY FOR PLANT VIABILITY. SOD SHALL BE LAID IN STAGGERED STRIPES, TIGHTLY AGAINST EACH OTHER WITHOUT STRETCHING OR OVERLAPPING. SOD STAKES SHALL USED ON ALL SLOPES 4:1 OR GREATER.
- CONTRACTOR SHALL REPAIR ALL DISTURBED AREAS (INTENDED OR UNINTENDED) AT A MINIMUM, TO THE ORIGINAL CONDITION UNLESS OTHERWISE NOTED.
- THE EXISTING PLANT MATERIAL SHOWN ON THIS PLAN IS INTENDED SOLELY TO IDENTIFY THEM AS OBSERVED IN THE FIELD. THIS DOES NOT MAKE ANY CLAIMS ABOUT THE CONDITION OR SAFETY OF ANY OF THE PLANT MATERIAL DESCRIBED HEREIN OR OBSERVED IN THE FIELD.
- ALL TRANSPLANTED PLANT MATERIAL MUST BE INSTALLED IMMEDIATELY UPON EXTRACTION FROM ITS ORIGINAL LOCATION, UNLESS SPECIFIC ARRANGEMENTS HAVE BEEN MADE WITH THE LANDSCAPE ARCHITECT/DESIGNER. SHOULD IT BECOME UNREASONABLE TO TRANSPLANT ANY OF THE PLANT MATERIAL AS DESCRIBED IN THIS PLAN, DUE TO SITE CONSTRAINTS OR OTHERWISE, CONTRACTOR IS RESPONSIBLE FOR CONTACTING LANDSCAPE ARCHITECT/DESIGNER TO MAKE ALTERNATIVE ARRANGEMENTS.
- THE CONTRACTOR SHALL BE RESPONSIBLE FOR MAINTAINING THE HEALTH AND VIABILITY OF THE PROPOSED PLANT MATERIAL INCLUDING WATERING, PROTECTION FROM PHYSICAL DAMAGE FROM THE TIME PLANT IS SELECTED THROUGH IT'S INSTALLATION.
- CONTRACTOR IS RESPONSIBLE FOR ALL PLANT MATERIAL REMAINING PLUMB UNTIL THE END OF THE GUARANTEE PERIOD. PLANTS MAY NOT BE STAKED UNLESS APPROVED BY THE LANDSCAPE ARCHITECT/DESIGNER.
- CONTRACTOR TO GUARANTEE PLANT MATERIAL AND LABOR FOR A MINIMUM OF ONE YEAR FROM THE TIME OF INSTALLATION.
- THE CONTRACTOR IS RESPONSIBLE FOR BECOMING FAMILIAR WITH AND ABIDING BY THE LANDSCAPE ORDINANCES FOR THE SPECIFIC JURISDICTION IN WHICH THE WORK IS TAKING PLACE.
- BIDDERS SHALL BE RESPONSIBLE FOR EXAMINING THE SITE, PRIOR TO PREPARING BID, TO BECOME FAMILIAR WITH THE SPECIFIC SITE CONSTRAINTS.
- ALL EXISTING ON-SITE PLANT MATERIAL NOT EFFECTED BY CONSTRUCTION OR THE PROPOSED LANDSCAPE, SHALL BE PROTECTED AS PART OF THIS PLAN. EXISTING LANDSCAPE IN AREAS OF CONSTRUCTION AND PROPOSED LANDSCAPE SHALL BE REMOVED AS PART OF THIS PLAN.
- THE CONTRACTOR SHALL FURNISH ALL LABOR, MATERIALS AND EQUIPMENT NECESSARY FOR THE COMPLETION OF ALL THE ITEMS SHOWN ON THE PLANS.
- IF IRRIGATION IS DEEMED NECESSARY, THE DESIGN AND INSTALLATION OF THE IRRIGATION SYSTEM SHALL BE THE RESPONSIBILITY OF THE LANDSCAPE CONTRACTOR. AN IRRIGATION PLAN ALONG WITH AN "AS BUILT" OF THE IRRIGATION SYSTEM SHALL BE PREPARED FOR OWNER REVIEW AND APPROVAL. CONTRACTOR SHALL GUARANTEE PERFORMANCE, PARTS, AND LABOR FOR A PERIOD OF 1 YEAR FROM THE DATE OF FINAL APPROVAL.
- IF EXISTING IRRIGATION IS PRESENT ON SITE, CONTRACTOR SHALL ADJUST, ADD TO, OR SUBTRACT FROM, THE EXISTING IRRIGATION SYSTEM TO ACCOMMODATE ANY PROPOSED ALTERATIONS/ADDITIONS TO THE EXISTING LANDSCAPE. CONTRACTOR SHALL PROVIDE THE OWNER AN "AS BUILT" OF THE IRRIGATION SYSTEM AND ALL CHANGES TO THE SYSTEM AFFECTED BY THIS PROJECT.
- DURING THE BIDDING PROCESS, THE LANDSCAPE CONTRACTOR SHALL COORDINATE WITH THE GENERAL CONTRACTOR OR OTHER PARTIES RESPONSIBLE FOR THE OVERALL BIDDING OF THE PROJECT TO DETERMINE WHICH CONTRACTOR SHALL BE RESPONSIBLE FOR THE REQUIRED TOPSOIL RE-SPREAD PER THE FOLLOWING UNLESS OTHERWISE NOTED:
 - 4" MINIMUM IN GRASS OR SOD AREAS
 - 6" MINIMUM IN PLANTING AREAS
 - 12" MINIMUM IN LANDSCAPE ISLANDS

GENERAL NOTES:
 1. THESE PLANS ARE BASED ON THE OVERALL SITE PLAN DATED 8/7/24
 PROVIDED BY: SOLAR LANDSCAPE
 601 BANGS AVENUE
 ASBURY PARK, NJ 07712
 2. PRIOR TO CONSTRUCTION, CONTRACTOR TO CONTACT THE DESIGNER TO VERIFY THAT THEY ARE WORKING FROM THE MOST CURRENT SET OF PLANS AND SPECIFICATIONS.

NOTE:
 ALL EXISTING ON-SITE PLANT MATERIAL NOT EFFECTED BY CONSTRUCTION OR THE PROPOSED LANDSCAPE, SHALL BE PROTECTED AS PART OF THIS PLAN. EXISTING LANDSCAPE IN AREAS OF CONSTRUCTION AND PROPOSED LANDSCAPE SHALL BE REMOVED.

PLANT LIST

SHADE, FLOWERING, AND CONIFEROUS TREES				
QTY.	ABRV.	BOTANICAL NAME	COMMON NAME	SIZE
1	ABS	Amelanchier x grandiflora 'Autumn Brilliance'	Autumn Brilliance Serviceberry	6'
FLOWERING AND EVERGREEN SHRUBS				
QTY.	ABRV.	BOTANICAL NAME	COMMON NAME	SIZE
13	EGA	Thuja occidentalis 'Smaragd'	Emerald Green Arborvitae	7'
5	VWH	Hamamelis vernalis	Vernal Witchhazel	6'

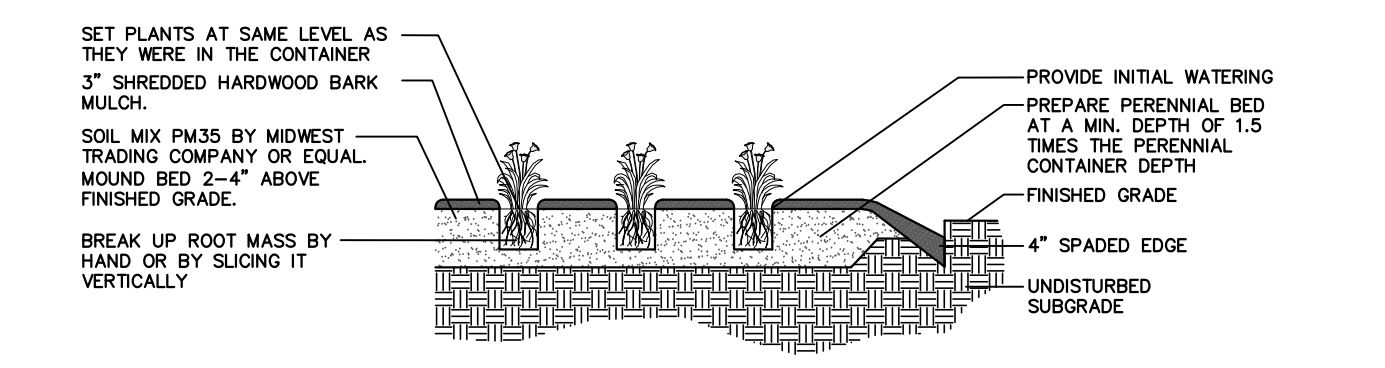

PERENNIAL PLANTING DETAIL
 NOT TO SCALE. USE ONLY ZONE HARDY PLANT MATERIAL.

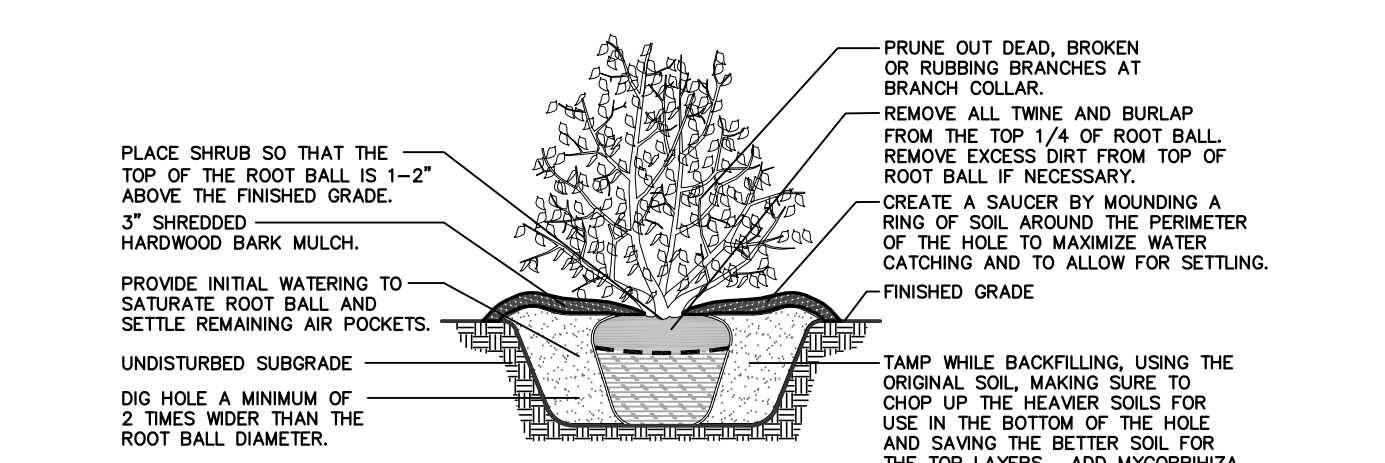

SHRUB PLANTING DETAIL
 NOT TO SCALE. USE ONLY ZONE HARDY PLANT MATERIAL.

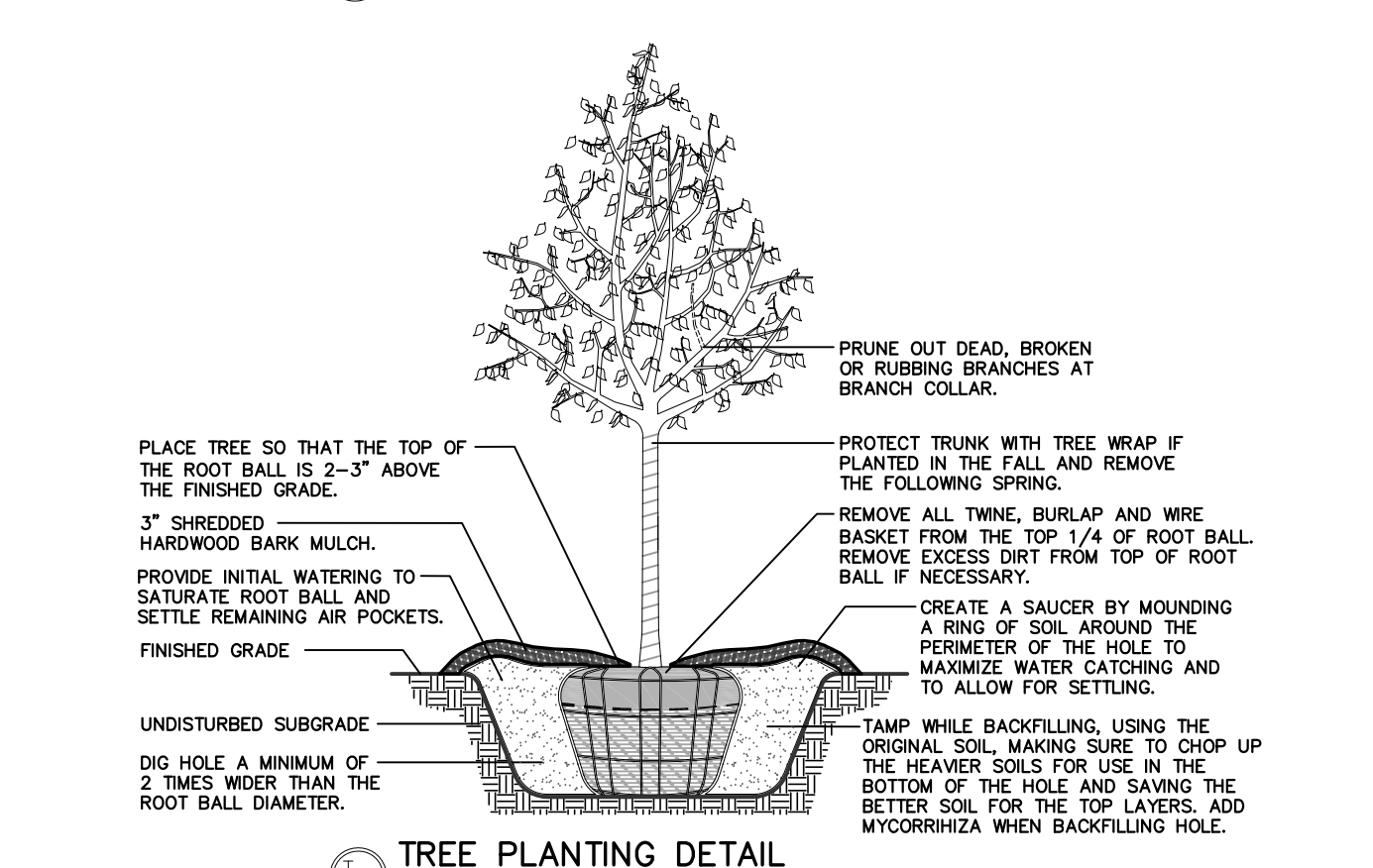

TREE PLANTING DETAIL
 NOT TO SCALE. USE ONLY ZONE HARDY PLANT MATERIAL.

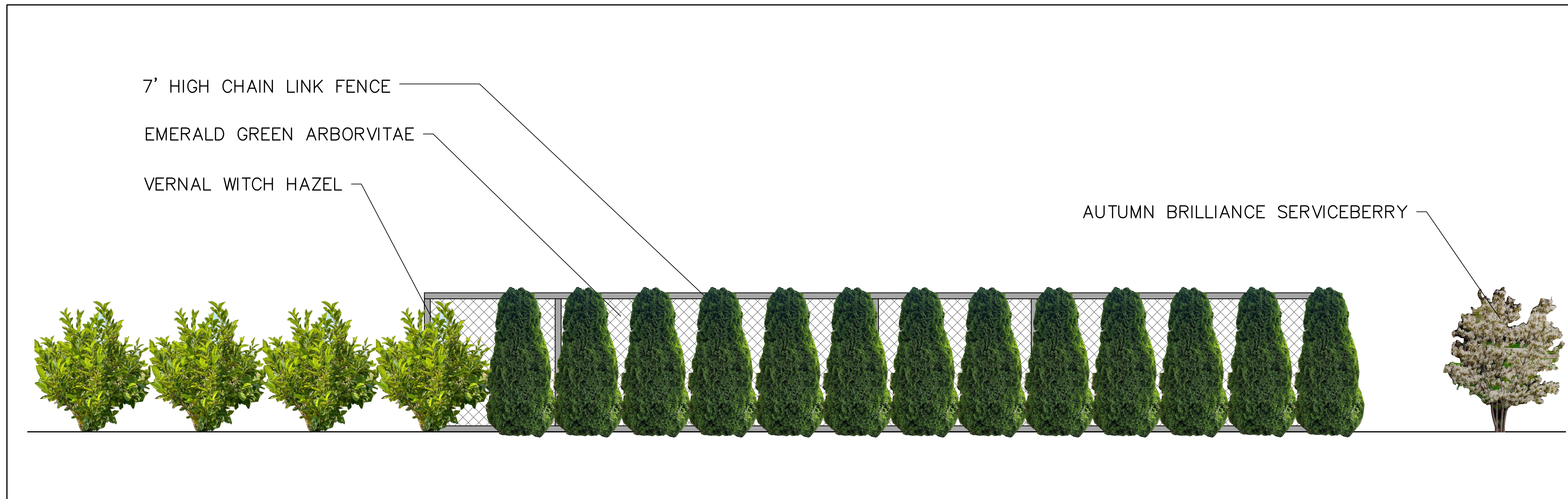

ELEVATION VIEW (NTS)

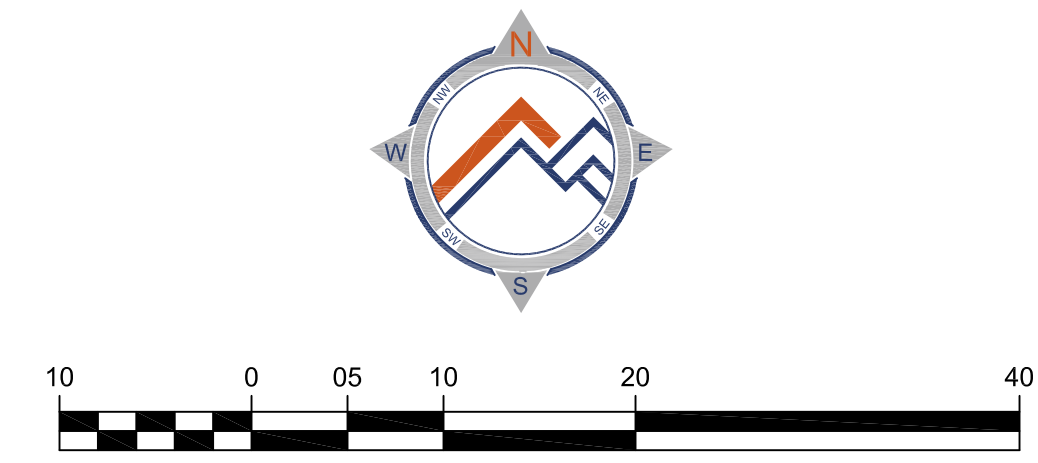
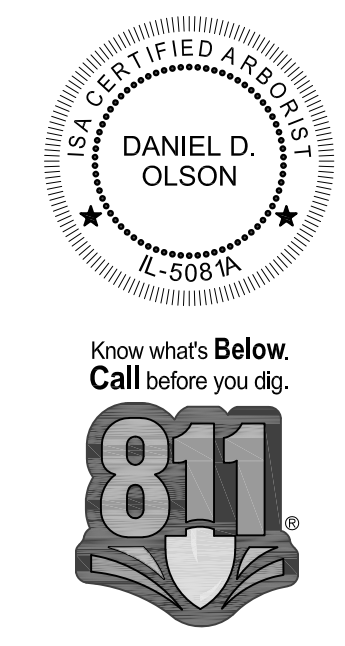

LANDSCAPE PLAN

DATE: 1/2/25
 NO.: 1
 REVISIONS: REVISED PLANT MATERIAL, ADDED FENCE, ADDED ELEVATION
 Prepared For:
Solar Landscape
 601 Bangs Avenue
 Asbury Park, NJ 07712
Public Storage Solar Installation - Schaumburg, IL
 1200 W Irving Park Rd.
 Schaumburg, Illinois
 Prepared By:

 DESIGN BY: D. OLSON
 DATE: AUGUST 16, 2024
 SCALE: 1" = 10'
 PROJECT NO.: 24-108
L-1
 LANDSCAPE PLAN

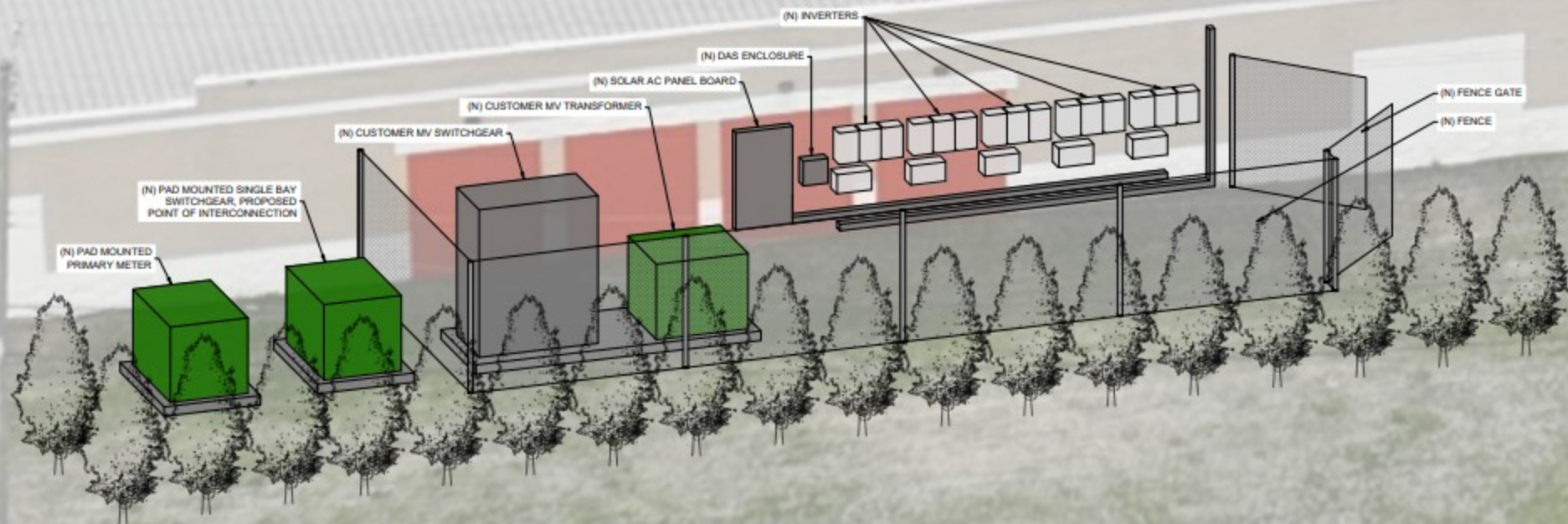

⊙ EQUIPMENT ELEVATION
SCALE: NTS

(N) PAD MOUNTED
PRIMARY METER

(N) PAD MOUNTED SINGLE BAY
SWITCHGEAR, PROPOSED
POINT OF INTERCONNECTION

(N) CUSTOMER MV SWITCHGEAR

(N) CUSTOMER MV TRANSFORMER

(N) SOLAR AC PANEL BOARD

(N) DAS ENCLOSURE

(N) INVERTERS

(N) FENCE GATE

(N) FENCE



EQUIPMENT ELEVATION
SCALE: NTS